

COASTAL PERFORMANCE
by Sunrise Windows, LTD.

Series 7290 Coastal Performance Twin Mullered Double Hung Window w/ Nailing Fin "IMPACT"

GENERAL NOTES

1. This product has been evaluated and is in compliance with the 6th Edition (2017) Florida Building Code (FBC) structural requirements excluding the "High Velocity Hurricane Zone" (HVHZ).
2. Product anchors shall be as listed and spaced as shown on details. Anchor embedment to base material shall be beyond wall dressing or stucco.
3. When used in areas requiring wind borne debris protection this product complies with FBC Sections 1609.1.2 & R301.2.1.2 and does not require an impact resistant covering. This product meets missile level "D" and includes Wind Zone 3 as defined in ASTM E1996 and FBC Sections 1609.1.2.2 & R301.2.1.2.1.
4. Site conditions that deviate from the details of this drawing require further engineering analysis by a licensed engineer or registered architect.

TABLE OF CONTENTS

SHEET #	DESCRIPTION
1	Typical elevations, design pressures & general notes
2	Vertical & cross sections
3	Horizontal cross sections
4	Buck & frame anchoring
5	Mullion details & cross section
6	Components
7	Bill of materials, components & glazing details

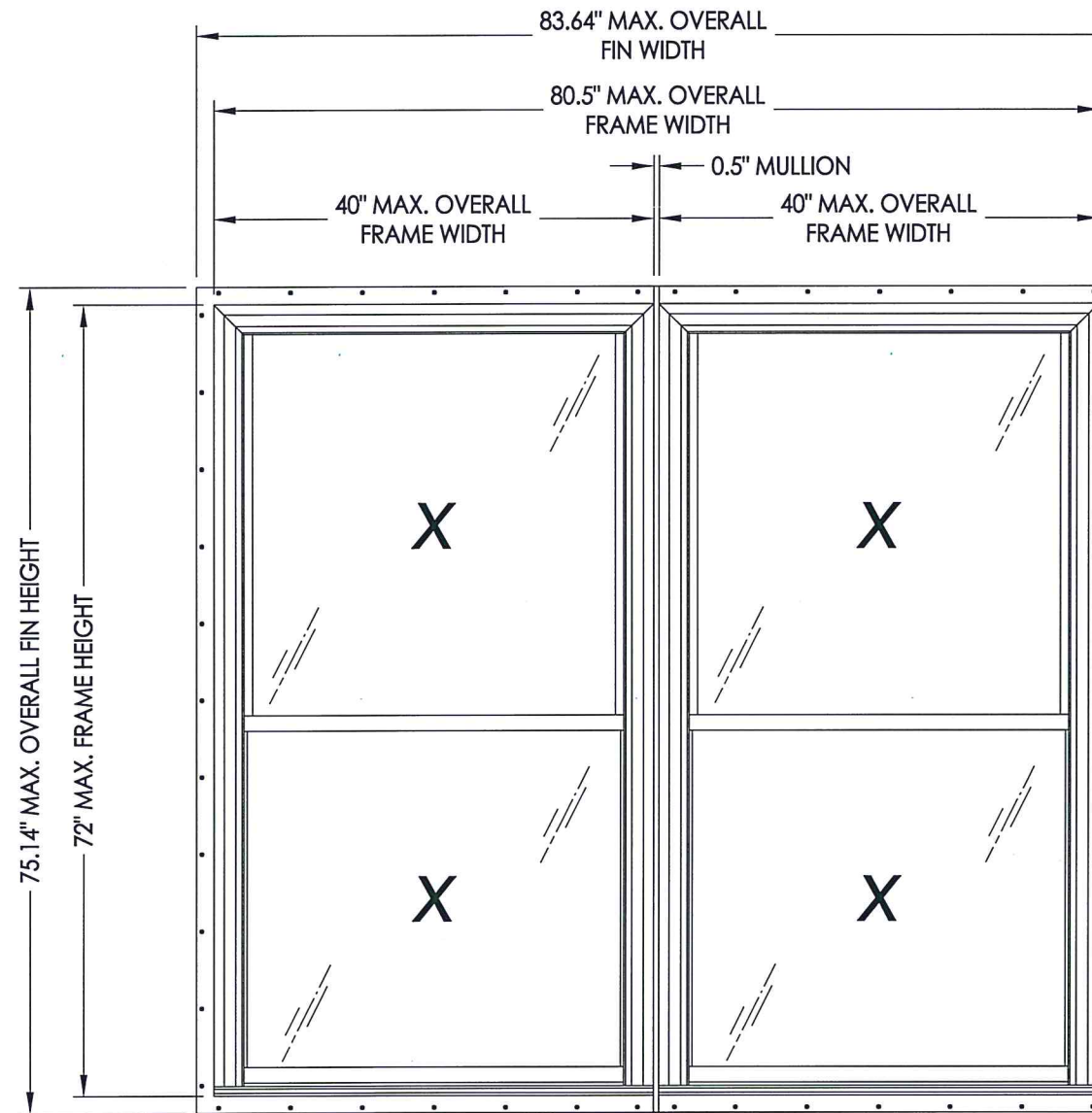

MAX. OVERALL FIN DIMENSION	MAX. OVERALL FRAME DIMENSION	MAX DAY LITE DIMENSION	GLASS TYPE	DESIGN PRESSURE (PSF)	
				POS.	NEG.
83.64" X 75.14"	80.5" X 72.0"	34.0" x 32.38"	G1	+50.0	-50.0

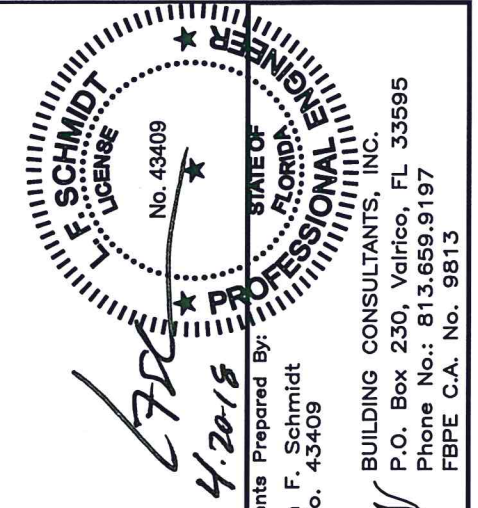

Documents Prepared By:
Lyndon F. Schmidt
P.E. No. 43409
R.W. BUILDING CONSULTANTS, INC.
P.O. Box 230, Valrico, FL 33595
Phone No.: 813.659.9197
FBPE C.A. No. 9813

PRODUCT: SUNRISE WINDOWS
PART OR ASSEMBLY: TYPICAL ELEVATION, DESIGN PRESSURES & GENERAL NOTES

NO.	DATE	BY	REVISIONS

DATE: 4/17/18
SCALE: N.T.S.
DWG. BY: JK
CHK. BY: LFS
DRAWING NO.: FL-26910.3
SHEET 1 OF 7

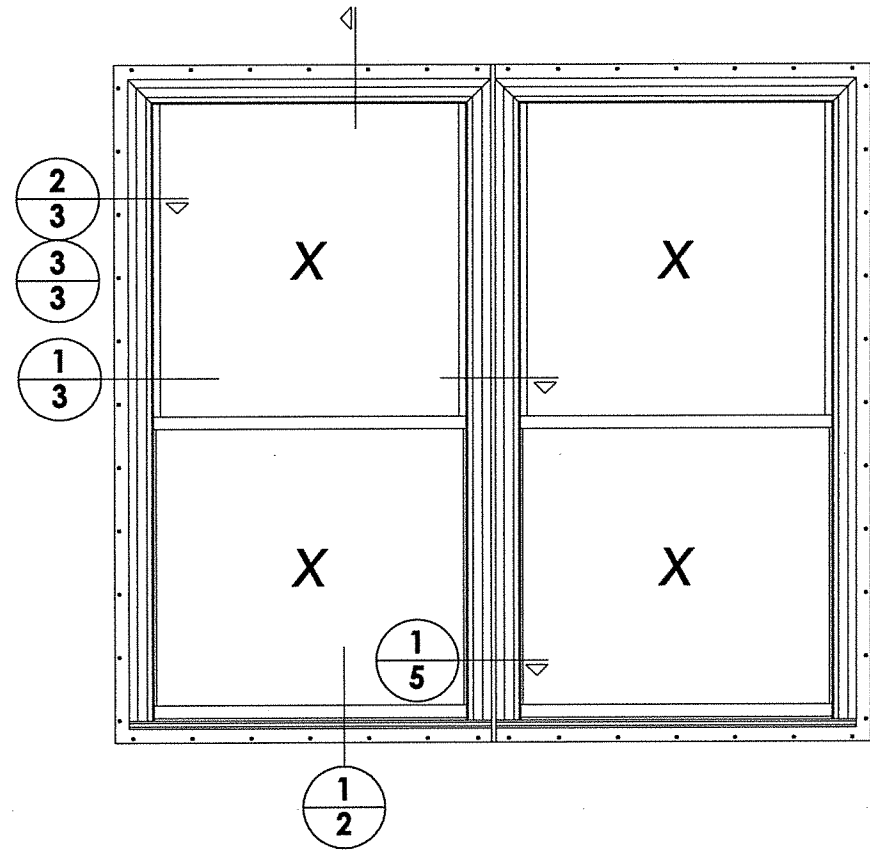

NOTE:
1. LOCK AND KEEPER LOCATED 9-3/4" FROM EACH END OF LOCK/MEETING RAIL.

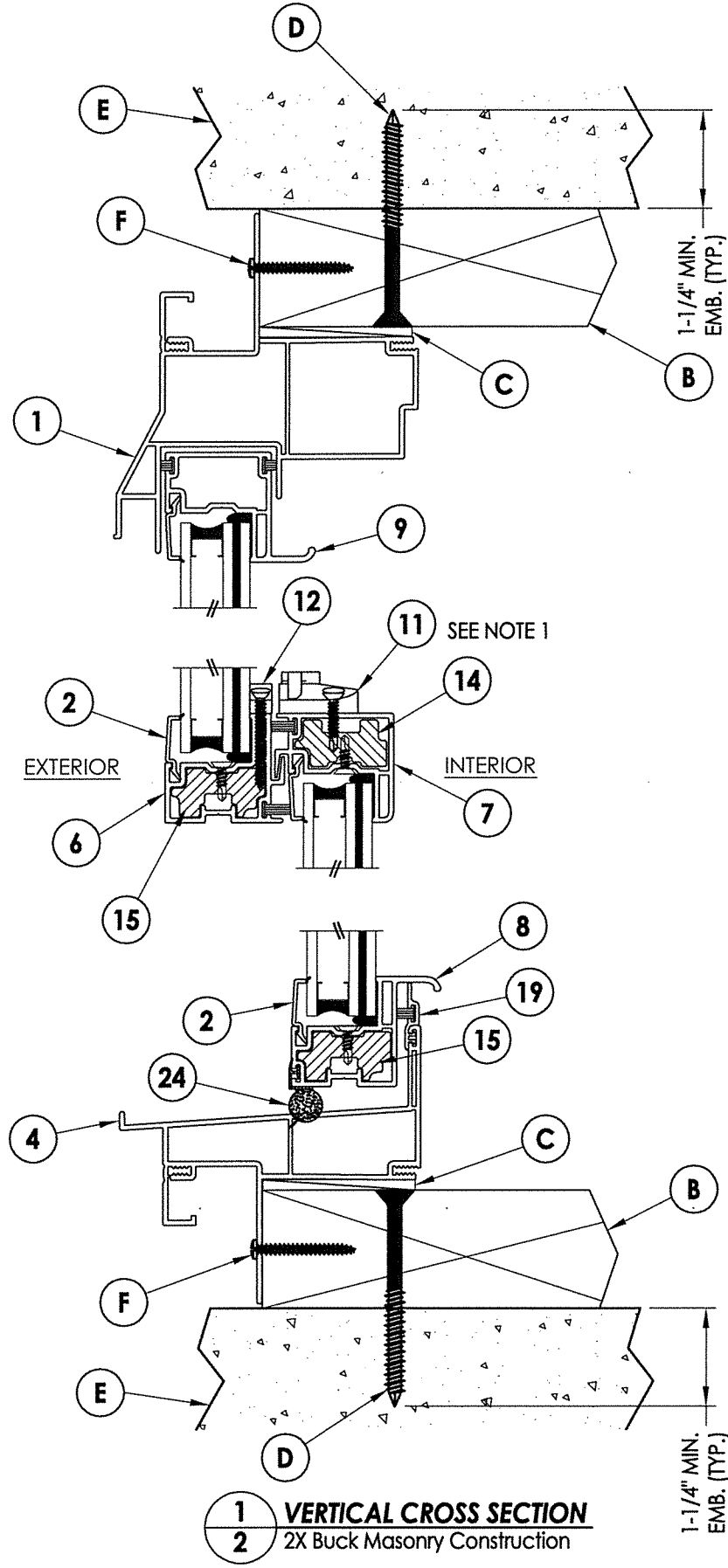

1 VERTICAL CROSS SECTION
2 2X Buck Masonry Construction

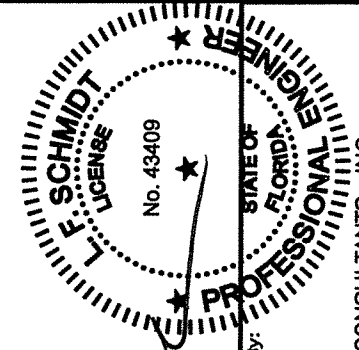

Documents Prepared By:
Lyndon F. Schmidt
P.E. No. 43409

LFS
4-20-18

R.W. BUILDING CONSULTANTS, INC.
P.O. Box 230, Valrico, FL 33595
Phone No.: 813.659.9197
FBPE C.A. No. 9813

PRODUCT:	SUNRISE WINDOWS		
PART OR ASSEMBLY:	VERTICAL CROSS SECTIONS		
DATE:	4/17/18		
SCALE:	N.T.S.		
DWG. BY:	JK		
CHK. BY:	LFS		
DRAWING NO.:	FL-26910.3		
SHEET	2 OF 7		
NO.	DATE	BY	REVISIONS

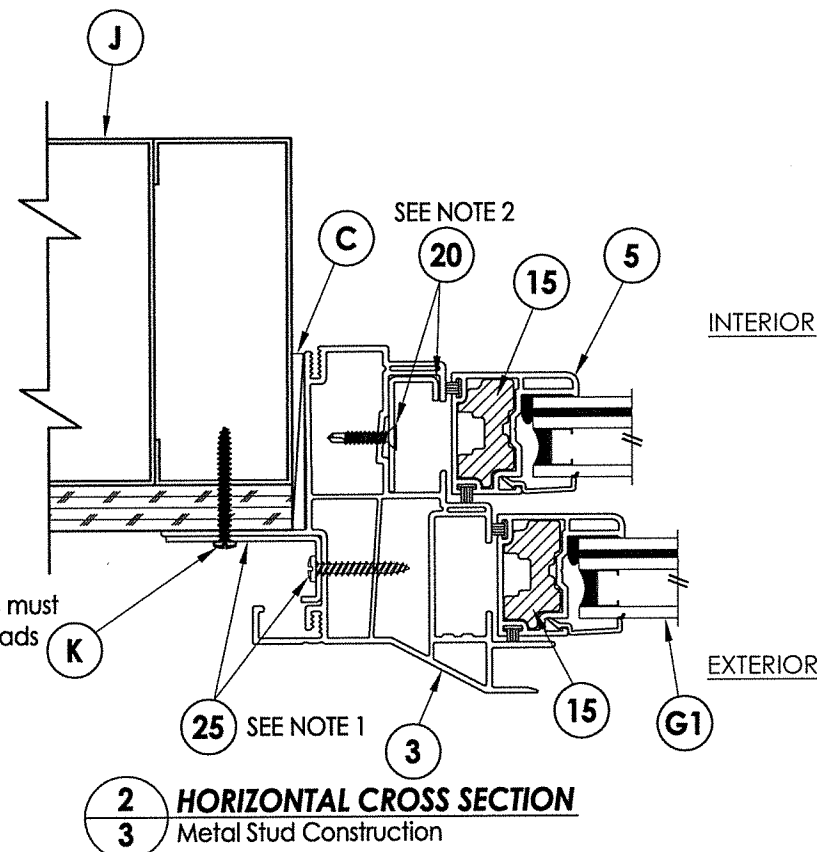

NOTE: Sheet Metal Screws must penetrate a min. of 3 threads through metal.

2 HORIZONTAL CROSS SECTION
3 Metal Stud Construction

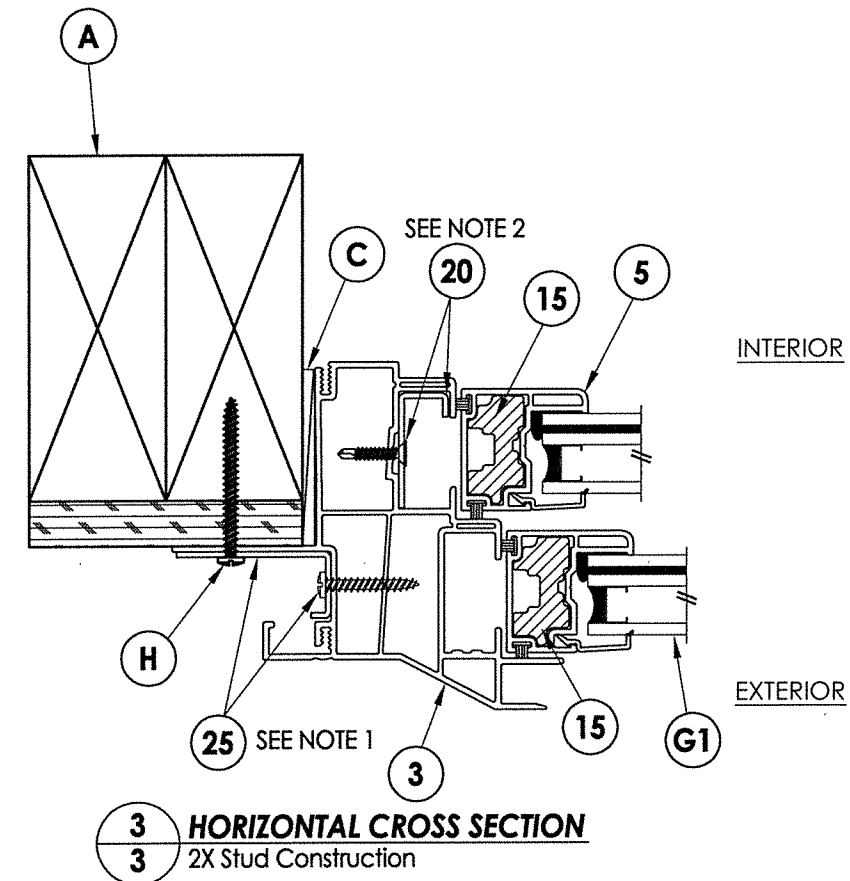

3 HORIZONTAL CROSS SECTION
3 2X Stud Construction

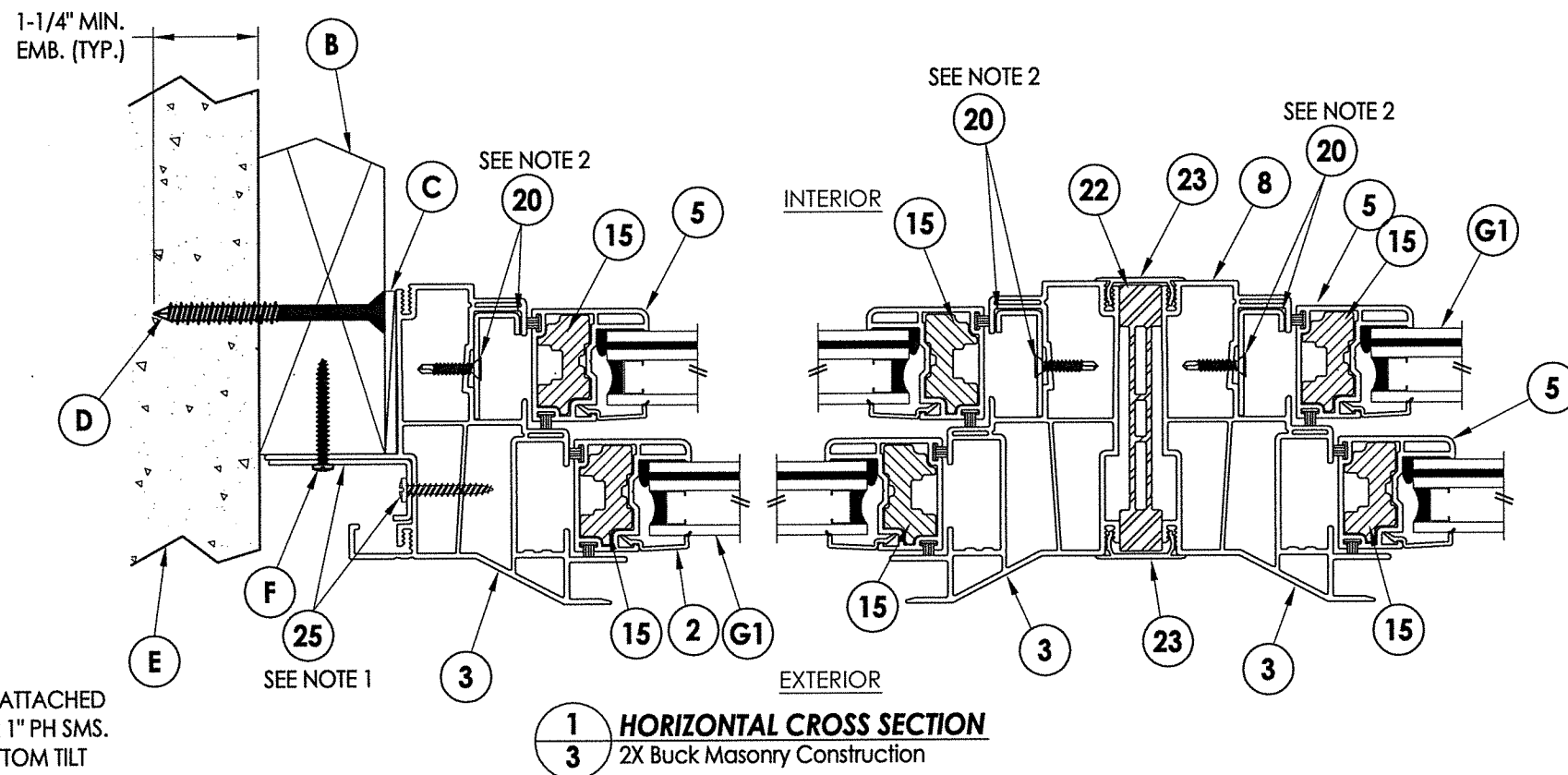

1 HORIZONTAL CROSS SECTION
3 2X Buck Masonry Construction

- NOTES:
1. 24" LONG "J"-CHANNEL REINFORCEMENT ATTACHED @ CENTERLINE OF EACH JAMB w/ (3) #8 x 1" PH SMS.
 2. JAMB REINFORCEMENT ATTACHED @ BOTTOM TILT LATCH POSITION w/ (1) #8 x 3/4" FH SMS.

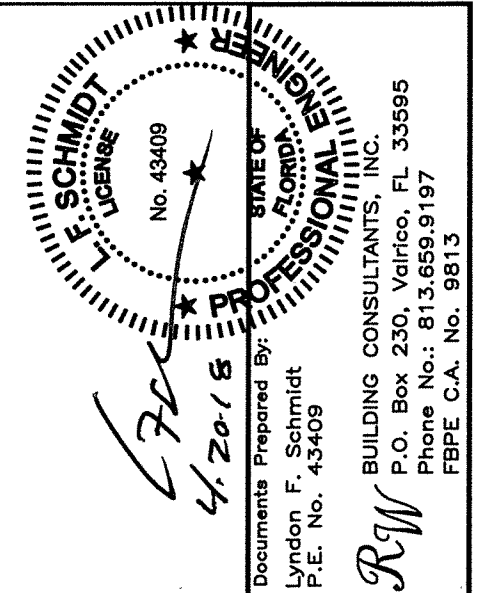

PRODUCT: SUNRISE WINDOWS

PART OR ASSEMBLY: HORIZONTAL CROSS SECTIONS

NO.	DATE	BY

DATE: 4/17/18
 SCALE: N.T.S.
 DWG. BY: JK
 CHK. BY: LFS
 DRAWING NO.: FL-26910.3
 SHEET 3 OF 7

R.W. BUILDING CONSULTANTS, INC.
 P.O. Box 230, Vairico, FL 33595
 Phone No.: 813.659.9197
 FBPE C.A. No. 9813

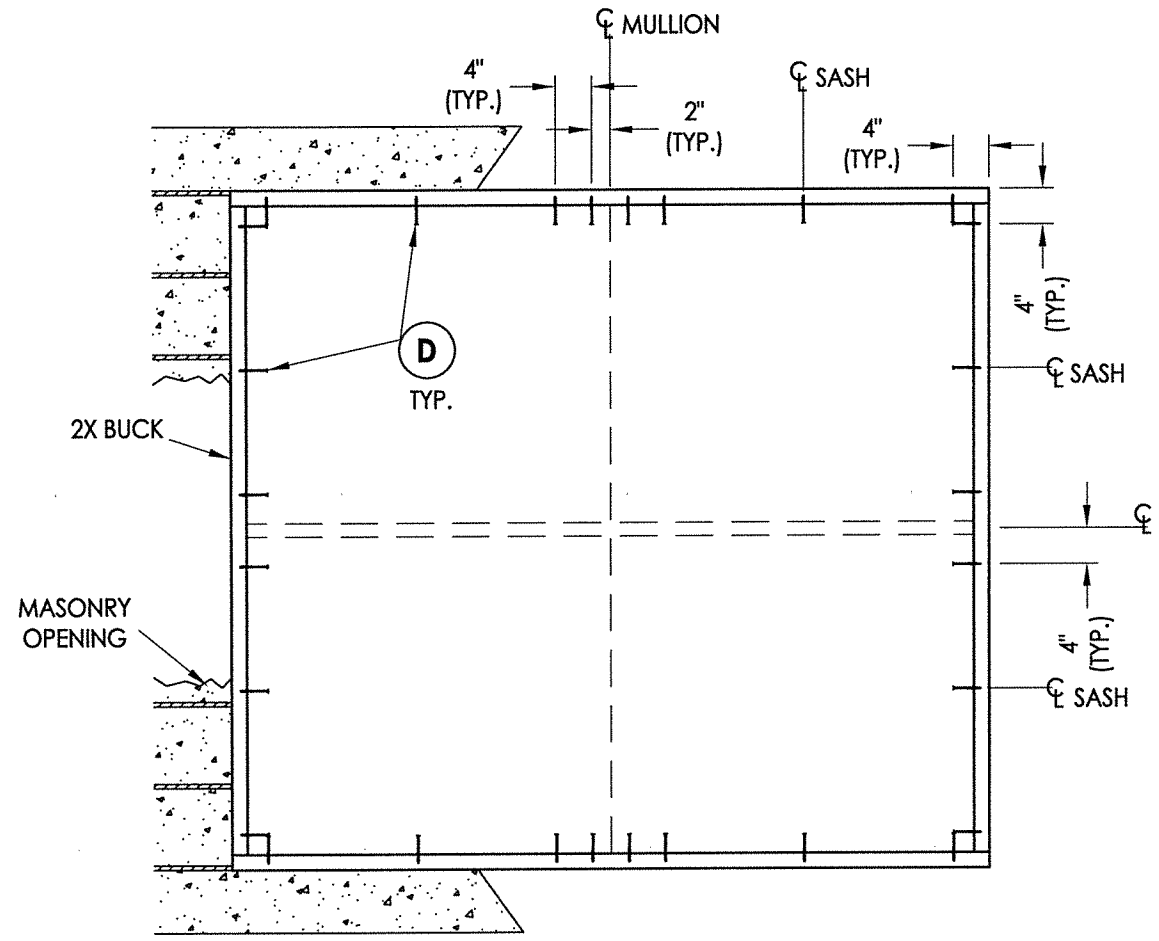

BUCK ANCHORING

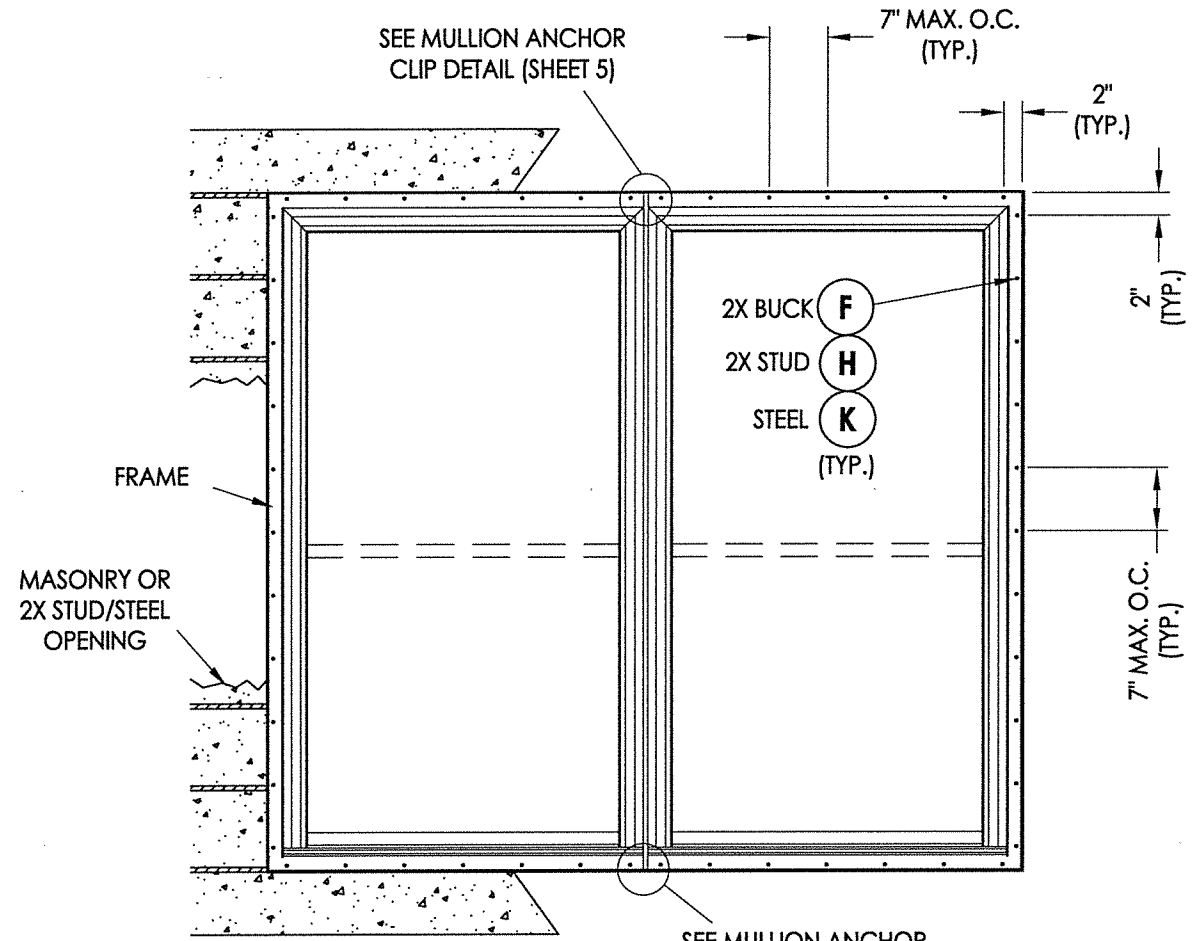

FRAME ANCHORING

CONCRETE ANCHOR NOTES:

1. Concrete anchor locations at the corners may be adjusted to maintain the min. edge distance to mortar joints.
2. Concrete anchor locations noted as "MAX. ON CENTER" must be adjusted to maintain the min. edge distance to mortar joints, additional concrete anchors may be required to ensure the "MAX. ON CENTER" dimension are not exceeded.
3. Concrete anchor table:

ANCHOR TYPE	ANCHOR SIZE	MIN. EMBEDMENT	MIN. CLEARANCE TO MASONRY EDGE	MIN. CLEARANCE TO ADJACENT ANCHOR
ITW TAPCON®	1/4"	1-1/4"	2"	4"
ELCO ULTRACON®	1/4"	1-1/4"	1"	4"

WOOD SCREW INSTALLATION NOTES:

1. Maintain a minimum 5/8" edge distance, 1" end distance, & 1" o.c. spacing of wood screws to prevent the splitting of wood.

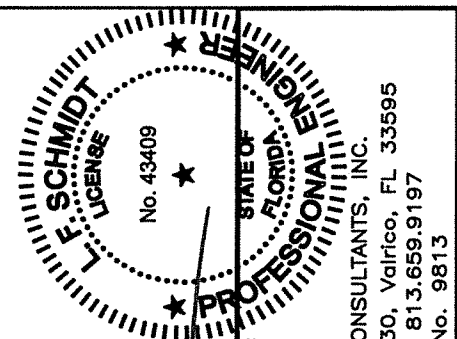

Documents Prepared By:
 Lyndon F. Schmidt
 P.E. No. 43409
 R.W. BUILDING CONSULTANTS, INC.
 P.O. Box 230, Valrico, FL 33595
 Phone No.: 813.659.9197
 FBPE C.A. No. 9813

PRODUCT: SUNRISE WINDOWS
 PART OR ASSEMBLY: BUCK & FRAME ANCHORING

NO.	DATE	BY

DATE: 4/17/18
 SCALE: N.T.S.
 DWG. BY: JK
 CHK. BY: LFS
 DRAWING NO.: FL-26910.3
 SHEET 4 OF 7

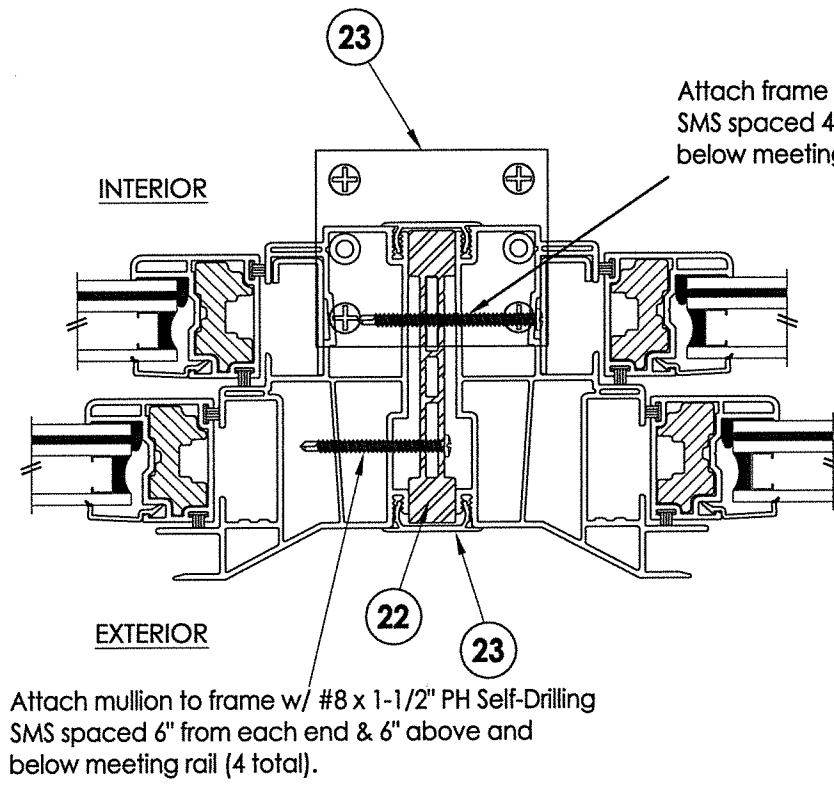
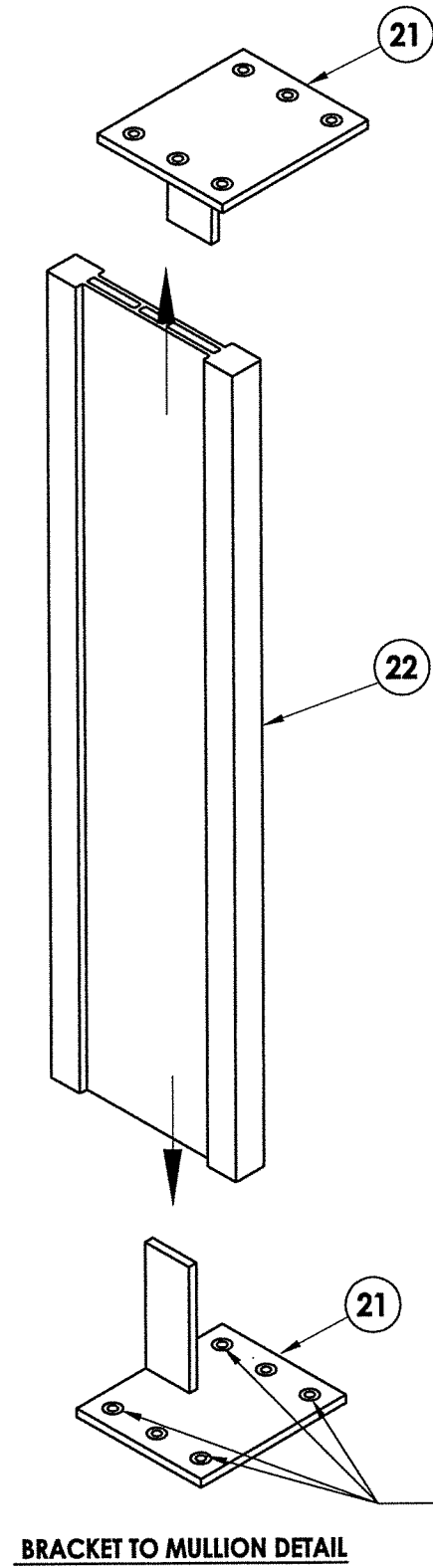

1 **5** **HORIZONTAL CROSS SECTION**
@ MULLION ANCHOR BRACKET

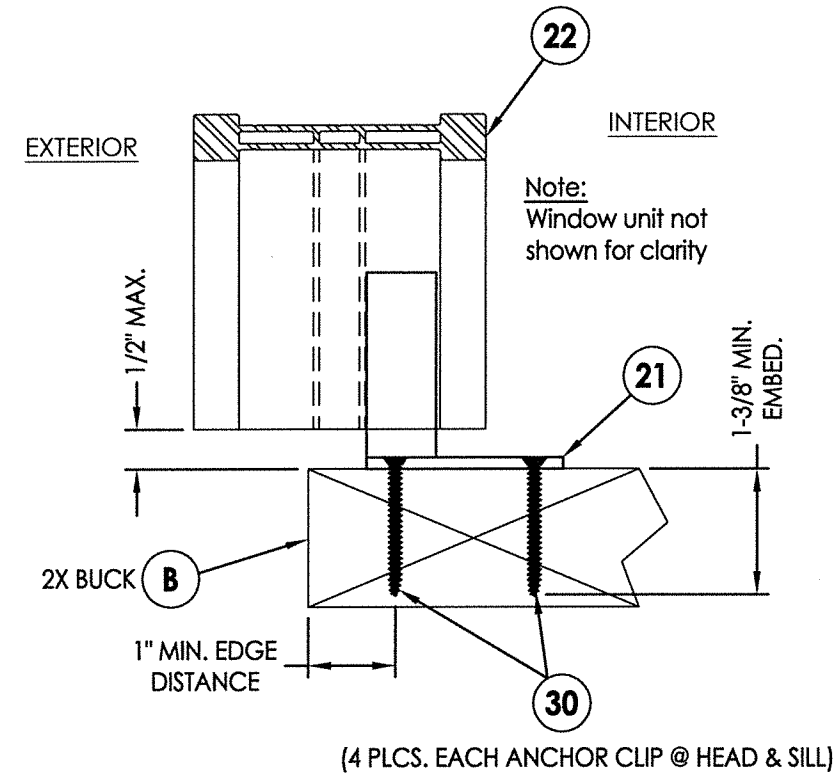

(4 PLCS. EACH ANCHOR CLIP @ HEAD & SILL)
MULLION ANCHOR CLIP DETAIL

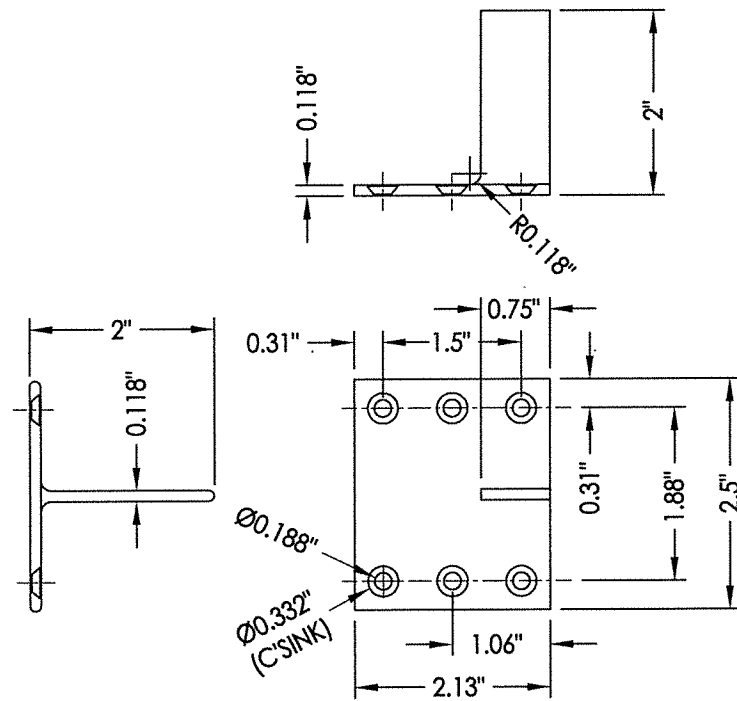

21 **MULLION ANCHOR BRACKET (5951)**
6063-T5 ALUM

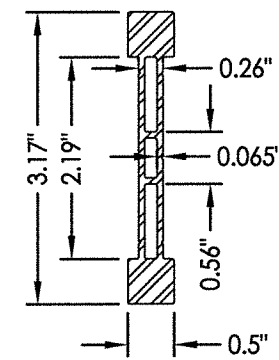

22 **MULLION (5902)**
6105-T5 ALUM

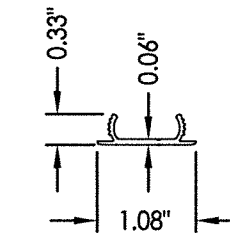

23 **MULLION COVER**

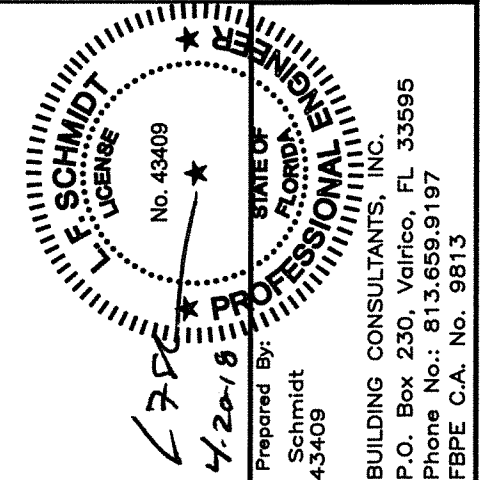

PRODUCT: SUNRISE WINDOWS		PART OR ASSEMBLY: MULLION DETAILS & CROSS SECTION	
DATE: 4/17/18		SCALE: N.T.S.	
DWG. BY: JK		CHK. BY: LFS	
DRAWING NO.: FL-26910.3		NO. DATE	
SHEET 5 OF 7		REVISIONS	
		BY	

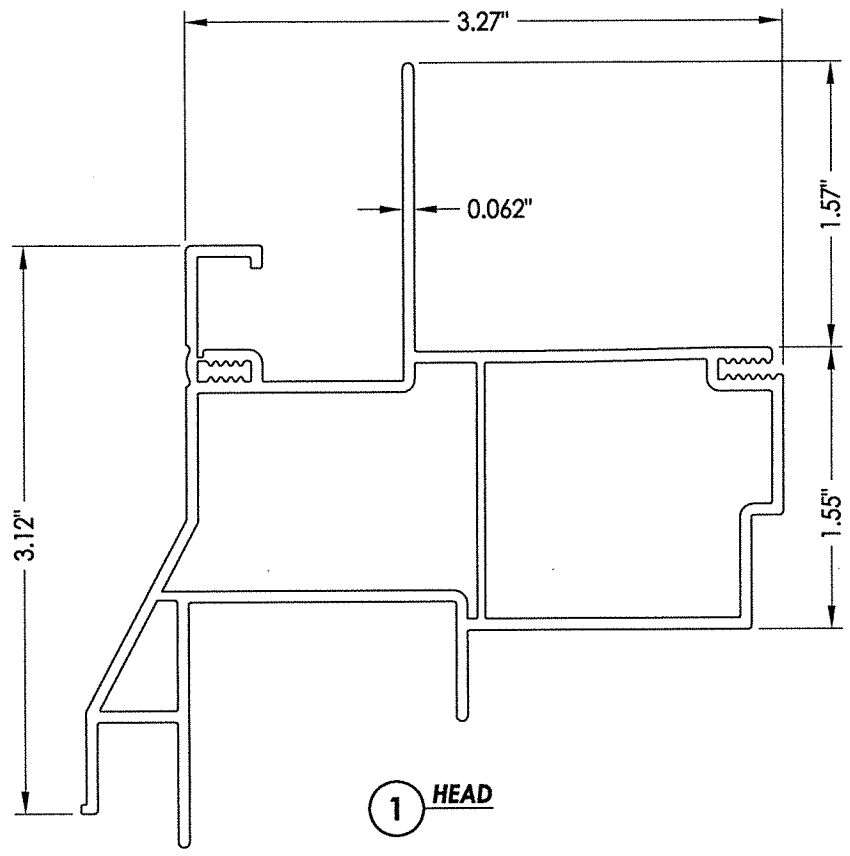

1 HEAD

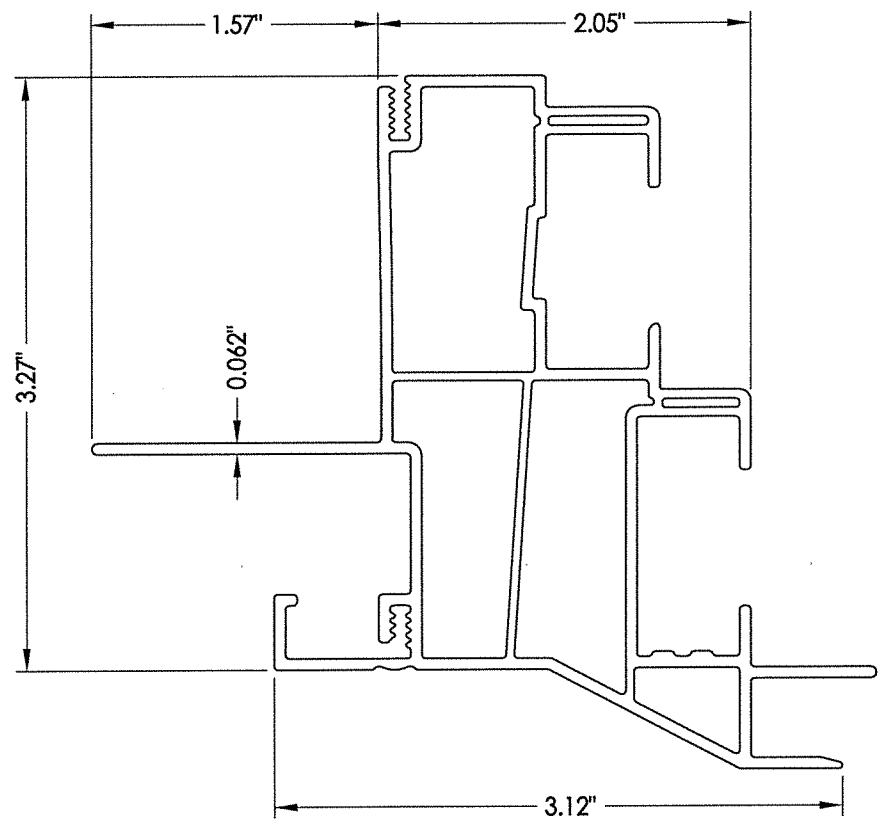

3 JAMB

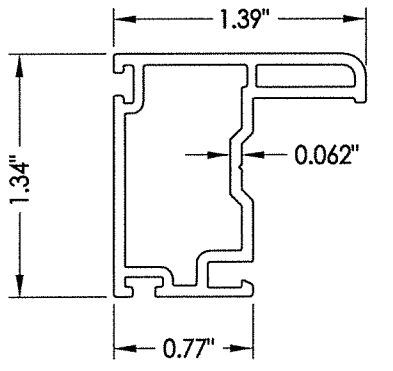

5 STILE

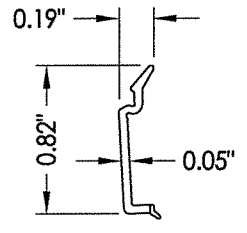

2 GLAZING BEAD

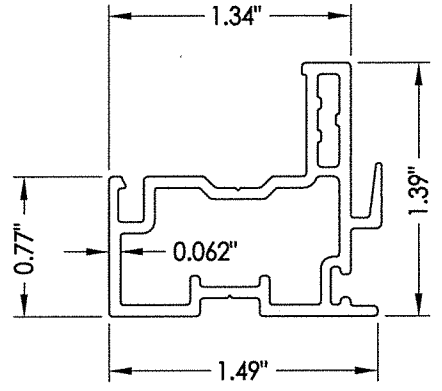

6 KEEPER RAIL

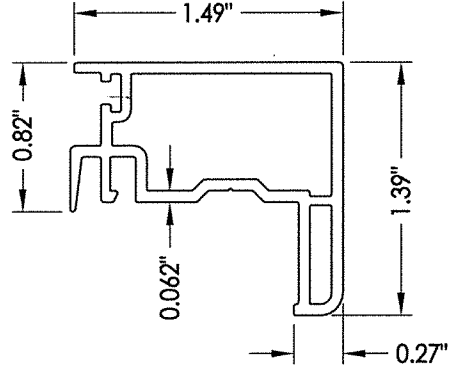

7 LOCK RAIL

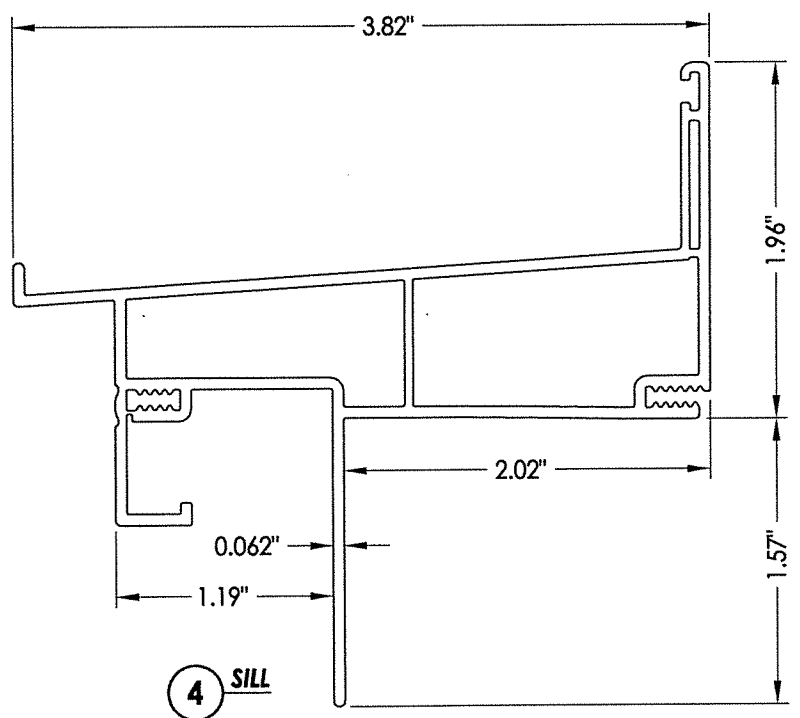

4 SILL

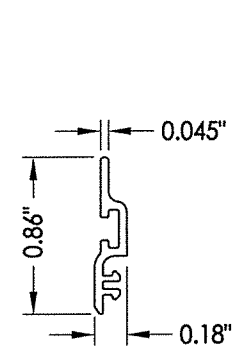

19 SILL RISER

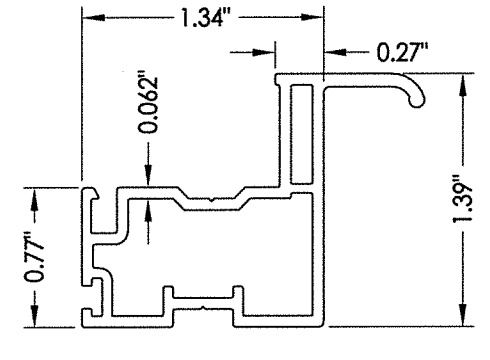

8 BOTTOM LIFT RAIL

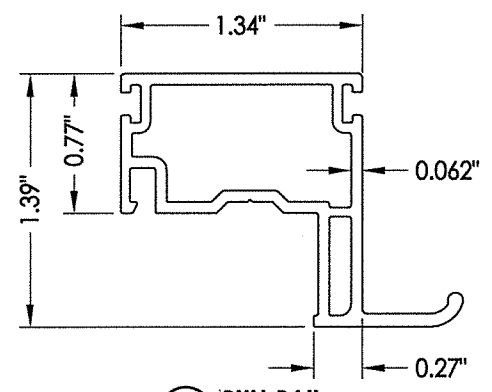

8 PULL RAIL

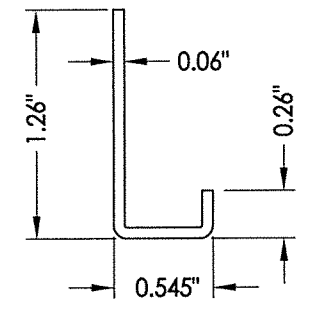

**20 JAMB REINFORCEMENT
1" WIDE**

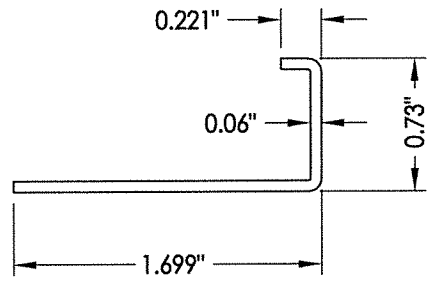

**25 J-CHANNEL REINFORCEMENT
24" WIDE**

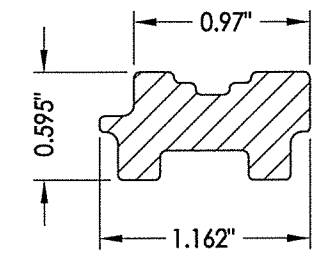

14 LOCK RAIL REINFORCEMENT

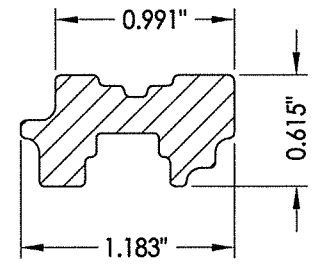

15 STILE/RAIL REINFORCEMENT

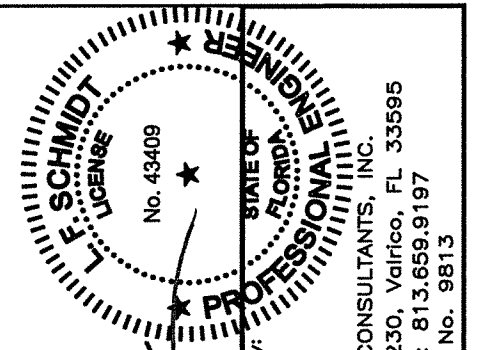

Documents Prepared By:
Lyndon F. Schmidt
P.E. No. 43409

RW BUILDING CONSULTANTS, INC.
P.O. Box 230, Valrico, FL 33595
Phone No.: 813.659.9197
FBPE C.A. No. 9813

PRODUCT:	SUNRISE WINDOWS
PART OR ASSEMBLY:	COMPONENTS

NO.	DATE	BY	REVISIONS

DATE: 4/17/18
SCALE: N.T.S.
DWG. BY: JK
CHK. BY: LFS
DRAWING NO.: FL-26910.3
SHEET 6 OF 7

